

**ENVIRONMENT  
HEALTH  
SAFETY**



**CLEAN WORKSHOP  
OIL SAVING  
OVERHEAD COSTS REDUCTION**

# GALILEO

**HIGH  
EFFICIENCY  
MOTORS**



**Air filter for removing oil mist in the presence of heavy amount**

## **MAXIMUM FILTRATION EFFICIENCY**

Combining the benefits of a new design, the dynamic and static filtration and an exclusive drainage system.

## **NO VIBRATION**

Special turbine studied not to withhold any particles on it, avoiding any possibility of vibration also with high presence of particulate.

## **QUICK MAINTENANCE**

Maintenance operation completed in less than 5 minutes!

Just two pieces filters to be washed or replaced at occurrence and simply by opening the rear cover.

## **LONG LIFE OF FILTER MEDIA**

Exclusive LOSMA drainage system guarantees higher drainage property, thus increasing the life of the filter media at the rear end.

## **COMPACT CONSTRUCTION**

Compact design and construction of unit facilitates placement and installation easily over any type of machine, directly or on top of a stand.

## **BENEFITS**

### **ENVIRONMENT**

Eliminates the air pollutants associated with most of the production and metalworking applications.

### **HEALTH**

Prevents skin and breathing disorders on your number one investment: the staff!

### **SAFETY**

Safeguards from accidents caused by slippery surfaces and fire hazard risks due to dispersed oil mist.

### **CLEAN WORKSHOP**

Improving working conditions, efficiency and company image.

### **OIL SAVING**

Converts the mist into oil and send it back to machine for re-use, avoiding any dispersion into the workshop and atmosphere.

### **HOUSEKEEPING COSTS REDUCTION**

No more oil mist deposits on floor, walls and machinery!

# Mist from workshop atmosphere, also with s of particulate.

## TECHNICAL SPECIFICATIONS

MODEL	MAX FLOW RATE* (m <sup>3</sup> /h)		NOISE (dBa) 50 Hz	INLET Ø (mm)	RPM (n. rpm)		NET WEIGHT (kg)	Power ** (kW)	
	50 Hz	60 Hz			50 Hz	60 Hz		50 Hz	60 Hz
<b>G 250</b>	260	300	58	79	2800	3360	10,5	0,09	0,11
<b>G 500</b>	600	650	68	98	2800	3360	14	0,25	0,28
<b>G 1000</b>	1000	1220	69	148	2800	3360	29	0,55	0,66
<b>G 2000</b>	2000	2250	70	148	2800	3360	34	1,1	1,3
<b>G 3000</b>	3000	3280	72	198	2800	3360	48	1,5	1,75

\*Free inlet \*\*Electrical motor 3 phases, 2 poles, protection index IP55, F insulation class

## WORKING PROCESS

The Galileo is equipped with a specially designed turbine that sucks in the oil mist and pollutants dispersed in the air from the working area.

Due to the acceleration effect caused by the centrifugal force, the oil mist coalesces and converts to the liquid state. This oil in the liquid state is then sent back to the machine through the LOSMA drainage system for re-use. A filter fitted at the rear of the unit, blocks and captures the smallest pollutants, preventing contaminants to be released into the workshop atmosphere.

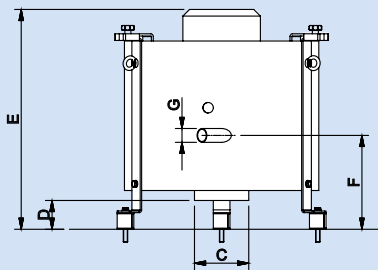
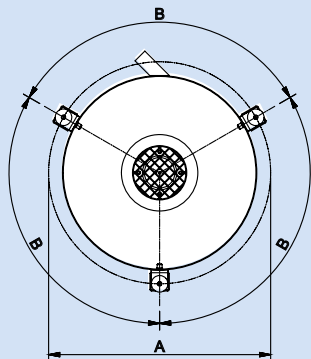

GALILEO					
Dimension (mm)	250	500	1000	2000	3000
Ø A	320	400	490	490	560
B(°)	120	120	120	120	90 (*)
Ø C	79	98	148	148	198
D	75	75	85	85	95
E	400	410	480	430	660
F	175	200	215	215	245
Ø G	25	25	25	25	25

(\*) 4 fixing supports on G3000 model

## AIR FLOW HEAD DIAGRAMS

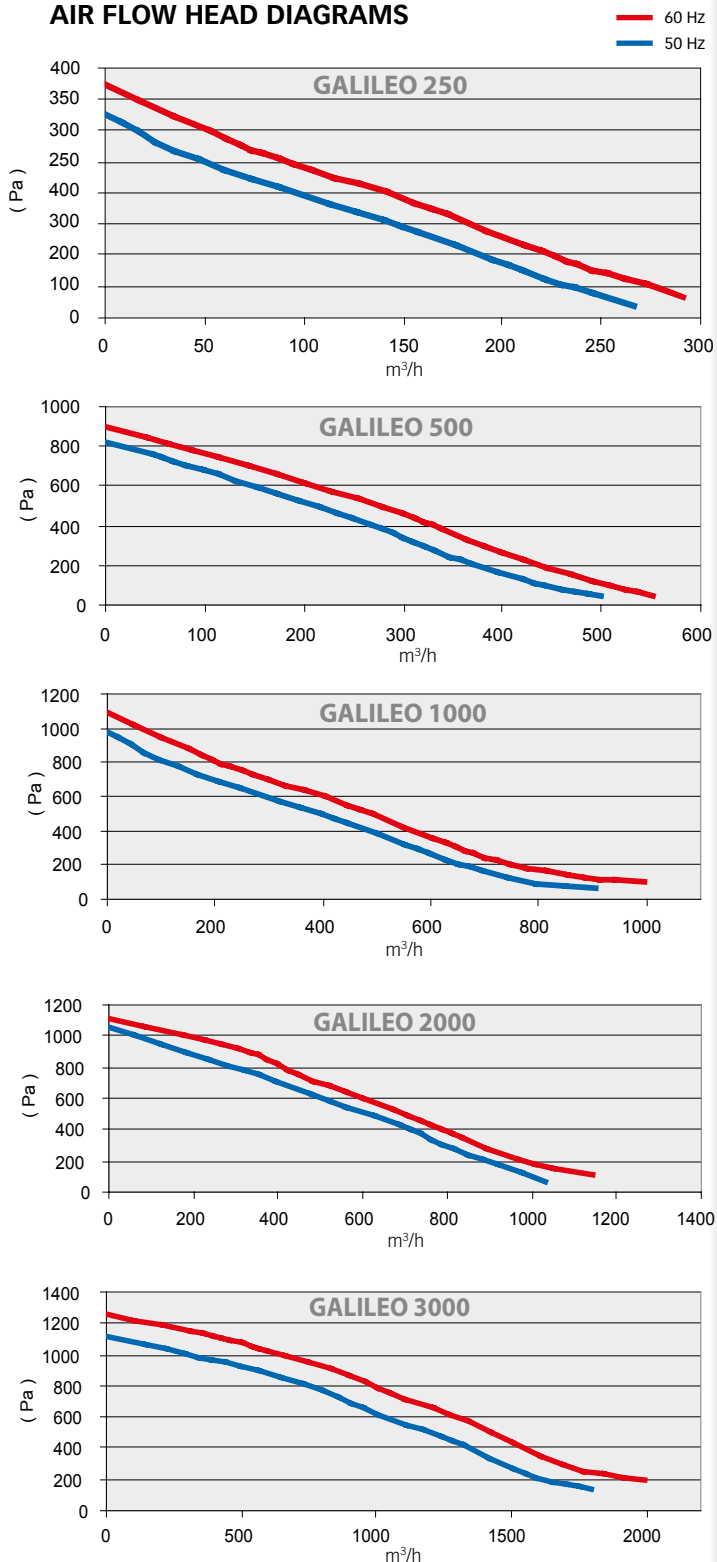

# GALILEO

## SUPER-FILTRATION UNIT

The high level of filtration of the GALILEO Series can be further expanded at any time a super-filtration unit by adding:

### G-Clipper:

HEPA\* cartridge after-filter for vapours and smokes till 99,95% filtration efficiency.

\*HEPA filter: high efficiency particulate air filter.

### G-Guard:

washable pre-filter for heavier applications with high quantity of oilmist, dust and swarf.



G-CLIPPER - G-GUARD					
Mod. (mm)	$\varnothing C$	H	I	J	$\varnothing K$
<b>G250</b>	79	105	765	310	254
<b>G500</b>	98	115	805	310	315
<b>G1000</b>	148	165	1090	425	380
<b>G2000</b>	148	165	1135	425	380
<b>G3000</b>	198	215	1225	355	460

## APPLICATIONS

Machine Tools, Food processing machinery, Energy equipment, Chemical machinery, other Process Equipment.



Since 1974, LOSMA S.p.A. has been producing systems for treatment of air contaminated by oil mist, smoke and odour produced in workshop atmosphere and systems for the filtration of coolants used in machine tool applications.

With the widest product range available on the market, LOSMA has become the undisputed point of reference for customers all over the world. The experience and know how of a highly qualified staff takes care of the design and engineering of the products, also for special developed solutions.



**LOSMA S.p.A.**  
Via E. Fermi, 16 - 24035 Curno (BG) Italy Tel. +39.035.461444  
Fax +39.035.461671 - info@losma.it - www.losma.com

Germany - Losma GmbH  
www.losma.de

U.S.A. - LOSMA Inc  
www.losma.com

UK - Losma UK Division  
www.losma.co.uk

Losma Engineering - Torino  
www.losma.it

India - Losma India Pvt Ltd  
www.losma.in

LOSMA S.P.A. reserves the right to make any modifications to the machine that it produces as it deems necessary without any warning.

ISO 9001-2008  
Certified Company  
501002810

